



KINGSMEDE

25 BLIGH STREET, SYDNEY

---

SUITE 24.04

---

AVAILABLE SEPTEMBER 2025

---

NLA - 80M<sup>2</sup>

---

8 PEOPLE

---

KINGSMEDE.COM.AU

*\*Photographs are indicative of final design*

# 25 Bligh St Amenities

- The Bureau
  - Dual level coworking/flex space
  - 1 to 9 desk private offices
  - Day passes
  - Bookable meeting & boardrooms
  - Podcast room
  - Event space hire
  - Business lounge
- Gym & squash court
- Serenity - luxury end of trip
- Secure touchless access
- Onsite management
- Interior design service
- 24/7 help desk

**Anita Wallbank**

LEASING ASSOCIATE



0403 589 979

AWALLBANK@KINGSMED.COM.AU

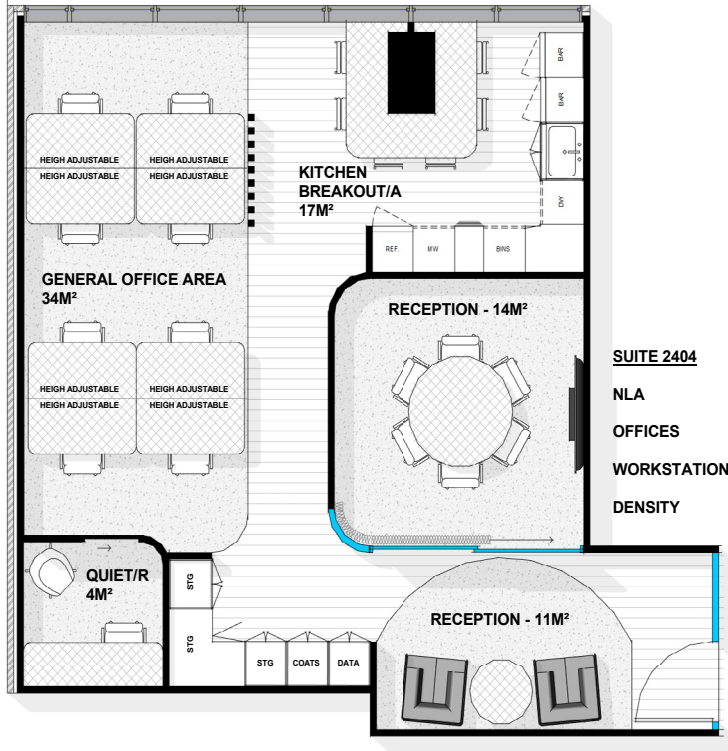

CURIOUS? VIEW OUR AVAILABILITIES



CONTACT FOR MORE INFO